

Carbon Film Leadless Fixed Resistors

Performance Specification

Temperature Coefficient	1R ~ 100K : $\pm 350\text{PPM}/^\circ\text{C}$ 101K ~ 500K : $\pm 700\text{PPM}/^\circ\text{C}$ 501K ~ 1M : $\pm 1000\text{PPM}/^\circ\text{C}$ 1M ~ 5.1M : $\pm 1500\text{PPM}/^\circ\text{C}$
Short Time Overload	$\pm(0.5\% + 0.005\Omega)\text{Max}$, with no evidence of mechanical damage.
Resistance to Soldering	$\pm(1.0\% + 0.05\Omega)\text{Max}$, with no evidence of mechanical damage.
Pulse Overload	$\pm(1.0\% + 0.05\Omega)\text{Max}$, with no evidence of mechanical damage.
Load Life	$\pm(2.0\% + 0.05\Omega)\text{Max}$, with no evidence of mechanical damage.
Load Life in Humidity	$\pm(5.0\% + 0.05\Omega)\text{Max}$, with no evidence of mechanical damage.
Solderability	95% Coverage Min.

Ordering Procedure: Ex.: MELF Carbon Film type 0204 1/4W-S +/-5% 75Ω Tape/Reel 3000

M C 2 4 S 4 J 0 7 5 0 T 3 0

Type:

MC24 = Carbon Film 0204
MC27 = Carbon Film 0207
MC39 = Carbon Film 0309

Wattage:

Small size:
S4 = 1/4W-S
S2 = 1/2W-S
1S = 1W-S
Extra Small size:
1U = 1W-SS
2U = 1W-SS

Resistance Value:

- E-24 series:
1st digit is "0"
2nd & 3rd digits are significant figures of the resistance
4th indicates the number of zeros
"J" ~ 0.1, "K" ~ 0.01
Ex. 4.7Ω ~ 47J, 4.7KΩ ~ 472

Packing Type:
T = Tape/Reel

Packing Qty:
2 = 2,000 pcs.
3 = 3,000 pcs.
B = 2,500 pcs.

Additional Information:
0 = NIL

Features

- SMD carbon resistor
- High tenninal strength
- Excellent solderability
- Suitable for Flow, Reflow and hand soldering

Derating Curve

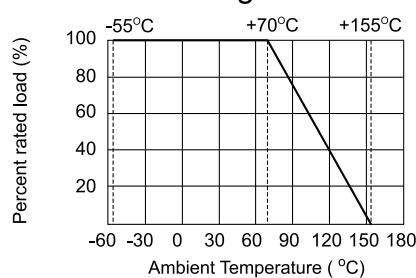

Tolerance:
G = $\pm 2\%$
J = $\pm 5\%$

1st color band

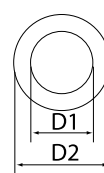
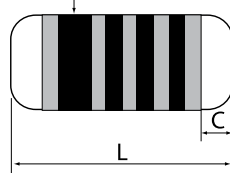

Part No.	Power Rating at 70 °C	Dimension (mm)				Resistance Range	Max Working Voltage	Max Overload Voltage	Std Packing (Reel)
		D1	D2 (Max)	L±0.2	C (Min)				
MC24S4	1/4W (0.25W)	1.4±0.15	1.55	3.5	0.5	1Ω ~ 5.1MΩ	200V	400V	3,000
MC27S2	1/2W (0.50W)	2.2±0.2	2.4	5.9	0.5	1Ω ~ 5.1MΩ	300V	600V	2,000
MC271U	1W	2.2±0.1	2.4	5.9	0.5	1Ω ~ 5.1MΩ	350V	700V	2,000
MC391S	1W	3.2±0.2	3.4	8.5	0.5	1Ω ~ 5.1MΩ	350V	700V	2,500
MC392U	2W	3.2±0.2	3.4	8.5	0.5	1Ω ~ 5.1MΩ	350V	700V	2,500